



Receptacles for connector

2.8 mm Timer Terminal

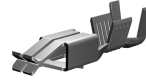

Figure	Part number	Wire size mm ² (AWG)	∅ Insulation (mm)	Brass Pre-Sn 01	Bronze 30	Bronze Pre-Sn 31	Material thickness (mm)	Winding number
	8400.**	0,5-1 (20-18)	1,5-2,1	•		•	0,32	5000
	8401.**		3,4 SEAL			•		3500
	8402.**	1-1,5 (18-16)	1,9-2,4	•		•		4500
	8407.**	1-2,5 (18-14)	2,4-3,6	•		•		4000
	8404.**	1,5-2,5 (16-14)	3-4,3	•		•		3500
	8403.**	1,5 (16)	3,4 SEAL			•		
	8405.**	2-3 (16-12)	3-4,3	•	•	•		

Receptacle Connectors

Figure	Part number	Ways	PA66V2 Black	PA66V2 Brown
	Central Polarization			
	2100917	8		•
	Left Polarization			
	2100915	8	•	

Receptacles for connector

6.3 mm Timer terminals

Figure	Part number	Wire size mm ² (AWG)	Ø Insulation (mm)	Brass	Brass Pre-Sn	Bronze	Bronze Pre-Sn	Material thickness (mm)	Winding number	
				00	01	30	31			
	8435.**	0,2-0,6 (24-20)	1,4-2,1	•	•	•	•	0,32	3500	
	8437.**	0,5-1 (20-18)	1,5-2,1	•	•	•	•			
	8437F**		FLR	•	•	•	•			0,4
	8441.**	0,5-1,5 (20-16)	1,8-3,3	•	•	•	•	0,32		
	8441F**		•	•	•	•	0,4			
	8442.**	0,75-1,5 (18-16)	1,8-2,3	•	•	•	•	0,32		
	8445.**	1-2,5 (18-14)	3-4,3	•	•	•	•	0,4		2700
	8445F**			•	•	•	•			
	8449.**	2-3 (16-12)	•	•	•	•	0,32	2500		



Receptacle Connectors

Figure	Part number	Ways	Dimensions	To terminal	PA66V2 Natural	PA66V2 White	
					10	11	
	8 ways Connector						
	26398**	8	9-40-25	8437.01	•		
	12 ways Connector						
	26385**	12	8,8-61-24	8437.01	•	•	

Receptacles for connector

Receptacle Connectors

Figure	Part number	Ways	Dimensions	To terminal	PA66V2 Natural	PA66V2 White
	26368**	8	9-40-25	8437.01	<input checked="" type="checkbox"/>	<input type="checkbox"/>

8 ways connector with locking