

4348.**



6.3 MM (.250) UP-STA RECEPTACLES FOR CONNECTOR - WITHOUT DIMPLE

Description Standard terminals for connector without dimple. Receptacles for 6.3*0.8 Tabs.



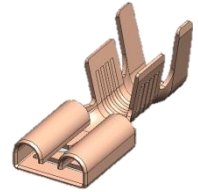

Wire section range 2.50 – 6.00 mm² (AWG 14 - 10)

Max. Insulator Ø 5.00 mm

DIN 46340



Materials, Temperature & Contact resistance

Part nr.	Material	Finish	Max. temp. (C°)	Resist. (mΩ)	UL regulation
4348.00	Brass	Natural	110	0.50	
4348.02	Brass	Tin plated	120	0.40	
4348.30	Bronze	Natural	120	0.60	
4348.32	Bronze	Tin plated	130	0.45	

Note: Maximal contact resistance: only contact area.

Material thickness 0.4 mm

Max. Rated current

Maximum Current values.

Values of the table show the recommended maximum current values, limited by the cross section of the cable used. These maximum values also depend on the ambient temperature, and can be reduced depending on the working conditions. For more precise information about the maximum rating current applicable in each case, consult the "Temperature Rise" and "De-rating" curves.

Wire section (mm ²)	Current (A)
2.5	20
4.0	26
6.0	34

Insertion/Withdrawal forces

	Natural	Tin plated
1 st . Insertion	≤ 30 N	≤ 40 N
1 st . Withdrawal	≤ 35 N	≤ 40 N
10 th Withdrawal	≥ 7 N	≥ 7 N

Application tool MN4425

Wire striping length 5.5 (±0.5) mm

Crimping parameters & Pull out force

Wire section (mm ² ±10%)		Conductor (mm) 		Insulator (mm)	Pull-out force (N)
Nominal	Actual	Height (±0,05)	Width (measured)	Width (measured)	ESCUBEDO
2.50	2.36	2.15	3.96	6.04	>270
4.00	3.54	2.35	3.99	6.04	>370
6.00	5.43	2.70	4.02	6.05	>520

Note: Values only valid for the application tool specified. The insulator width is only indicative as they depend of the insulation properties.

Packaging 4000 Pieces on 300 mm Ø x 160 mm wide cardboard reel, 21.4 mm terminal chain pitch

4348.**



6.3 MM (.250) UP-STA RECEPTACLES FOR CONNECTOR - WITHOUT DIMPLE

Drawing

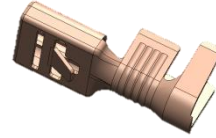
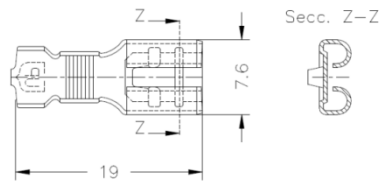
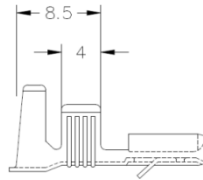

Approvals

- RoHS Compliant
- UL (See table above)



Connectors Compatibility

Part number	Color	Way	PA66V2	PA66V0	ABS	No Flame	
2635110	Natural	1	x				
2635210		2	x				
2635310		3	x				
2635410		4	x				
2635610		6	x				
2635810		8	x				
2637410		2	x				
2637810		2					
2637510		2	x				
2638610		6	x				
2639728	Grey	6 (3x2)			x		
2639010	Natural	5x2	x				
2638010		11	x				
2638710		12	x				
2635540		4					x
2635710				x			
2635730			12		x		
2635740							

Note: For others materials and colours consult: info@escubedo.com

Note. T.B.D. To be determined

4348.00 NATURAL BRASS



6.3 MM (.250) UP-STA RECEPTACLES FOR CONNECTOR - WITHOUT DIMPLE

Derating Curve. Current carrying capacity vs. Ambient Temperature

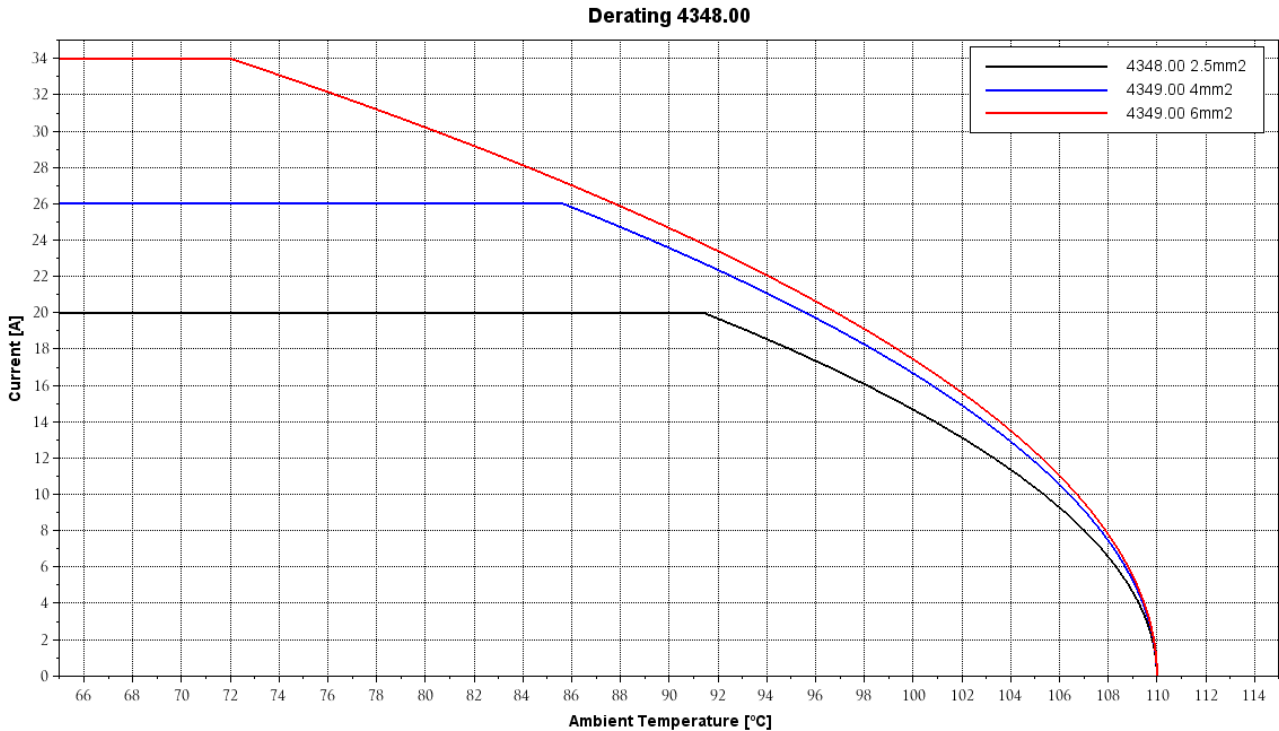

Temperature Rise Curve. Terminal Temperature rise due to the current carried

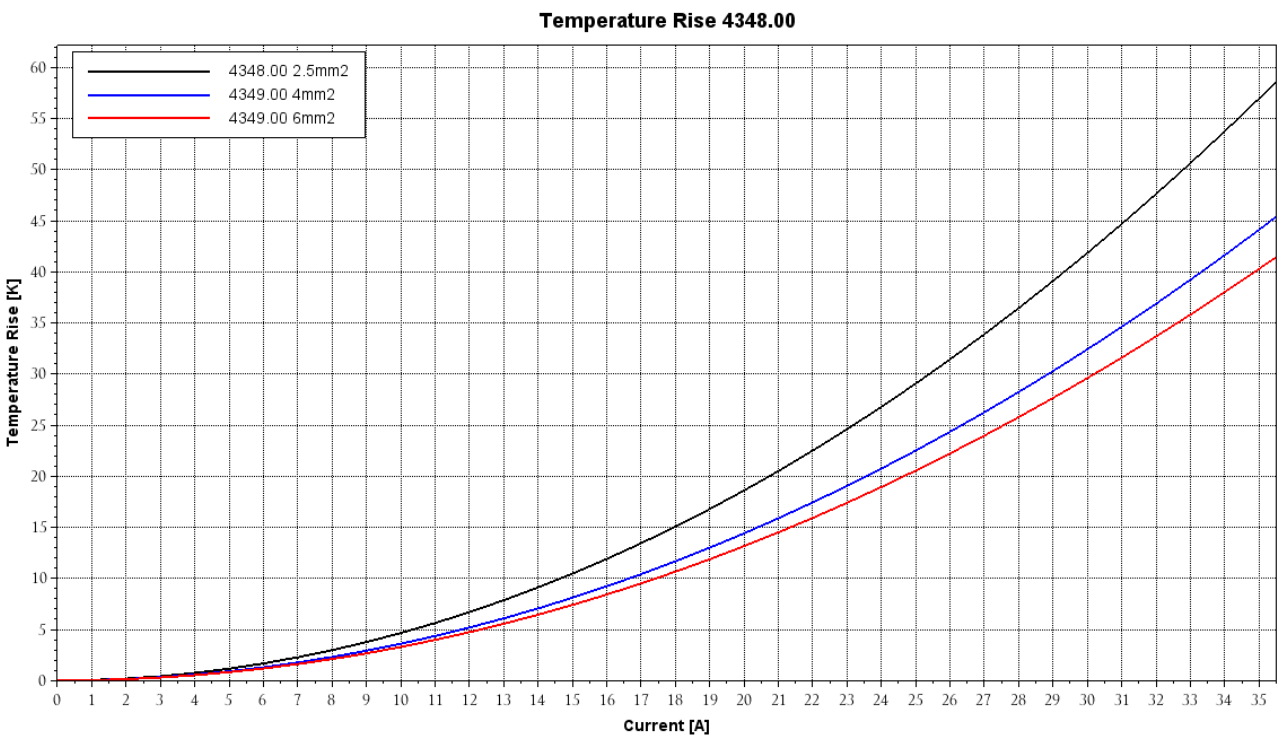

Curves show terminal behavior in a first connection, working in open air (without connector). Security margin has been applied.

4348.02 TIN PLATED BRASS



6.3 MM (.250) UP-STA RECEPTACLES FOR CONNECTOR - WITHOUT DIMPLE

Derating Curve. Current carrying capacity vs. Ambient Temperature

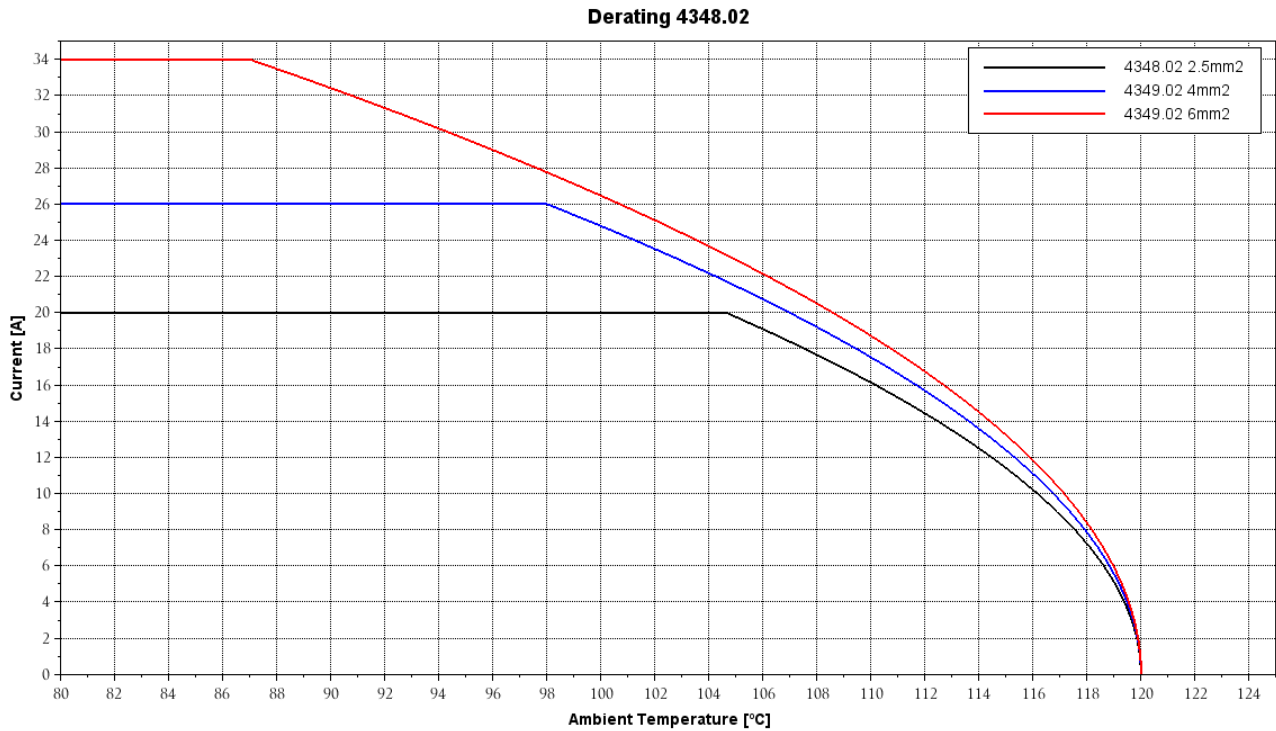

Temperature Rise Curve. Terminal Temperature rise due to the current carried

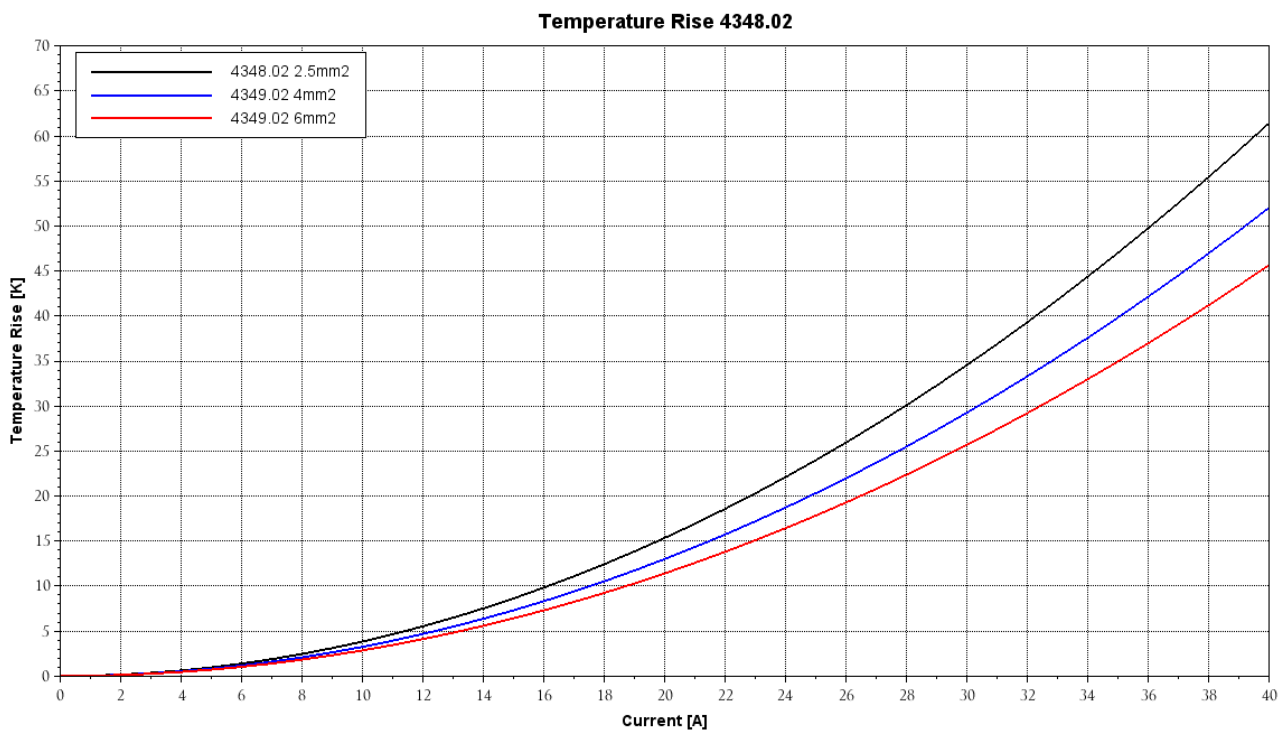

Curves show terminal behavior in a first connection, working in open air (without connector). Security margin has been applied.

4348.30 NATURAL BRONZE



6.3 MM (.250) UP-STA RECEPTACLES FOR CONNECTOR - WITHOUT DIMPLE

Derating Curve. Current carrying capacity vs. Ambient Temperature

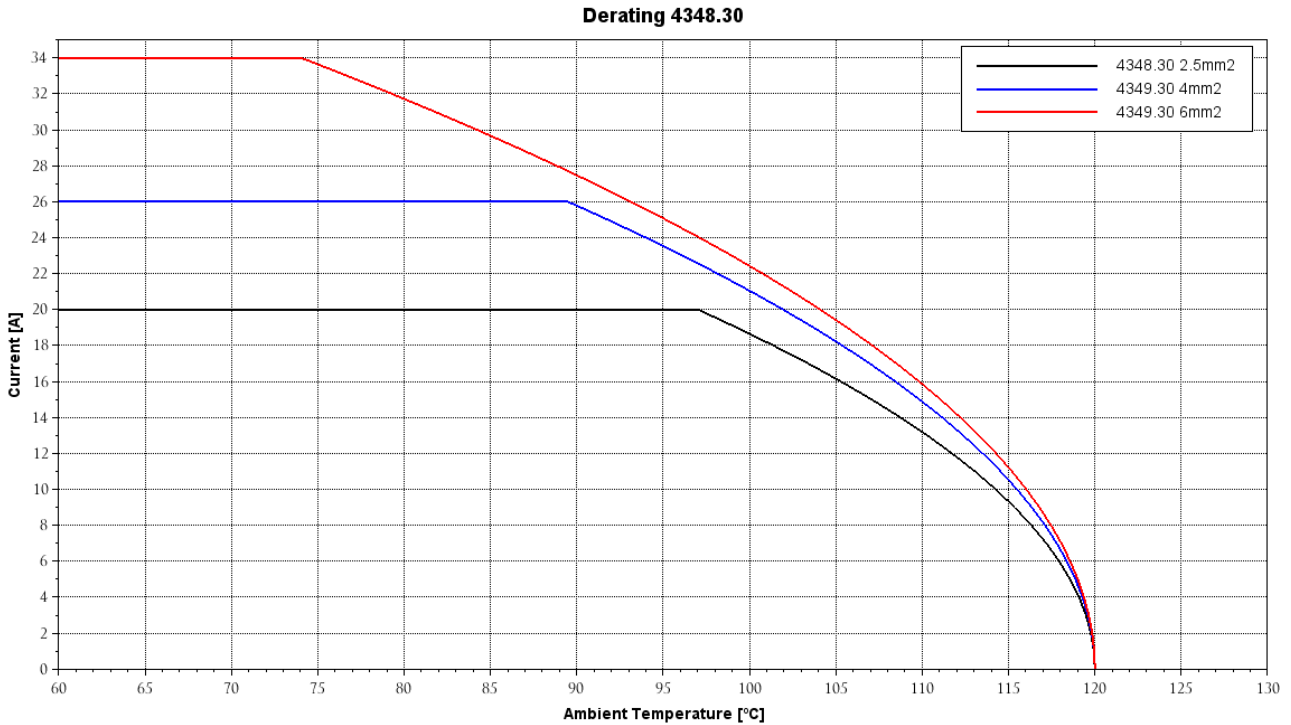

Temperature Rise Curve. Terminal Temperature rise due to the current carried

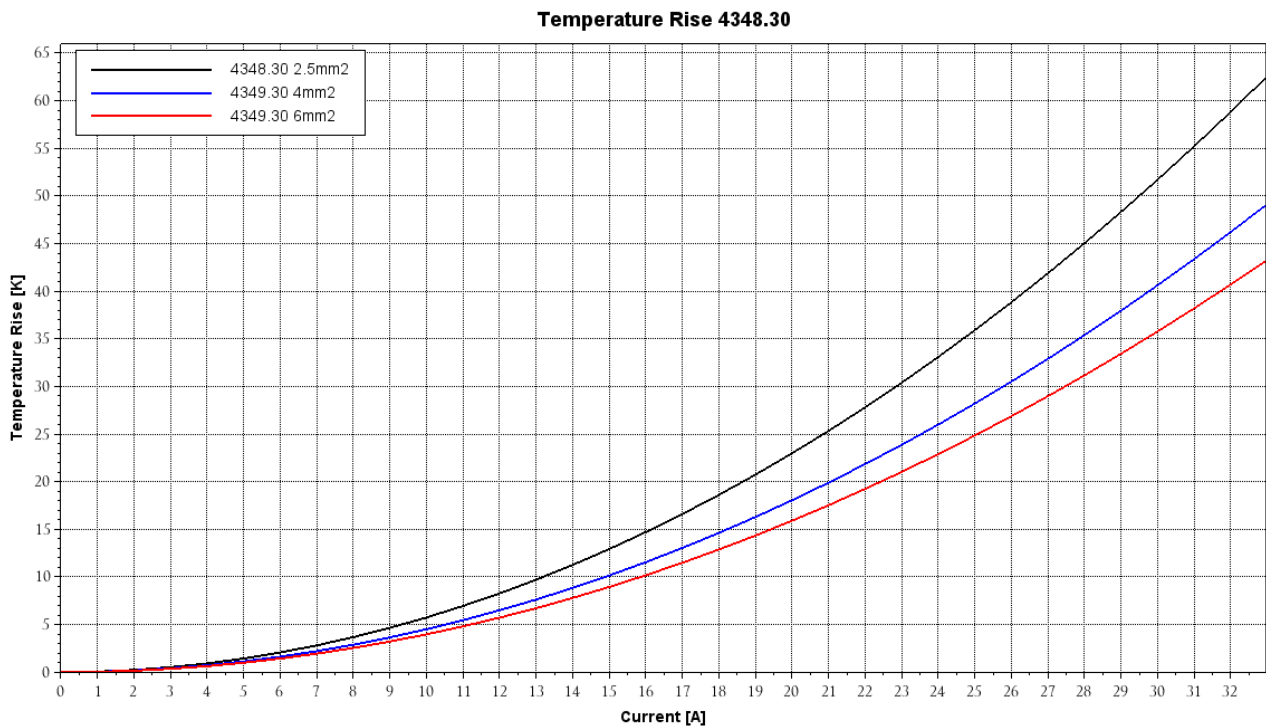

Curves show terminal behavior in a first connection, working in open air (without connector). Security margin has been applied.

4348.32 TIN PLATED BRONZE



6.3 MM (.250) UP-STA RECEPTACLES FOR CONNECTOR - WITHOUT DIMPLE

Derating Curve. Current carrying capacity vs. Ambient Temperature

Derating 4348.32

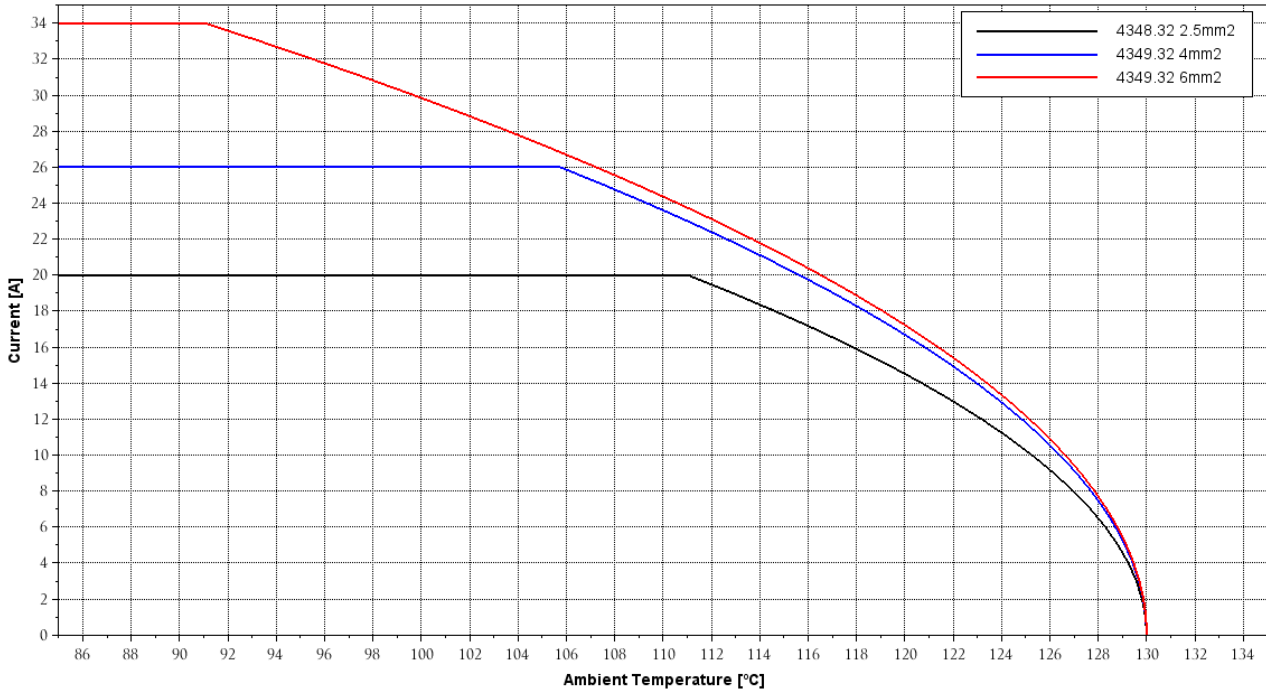

Temperature Rise Curve. Terminal Temperature rise due to the current carried

Temperature Rise 4348.32

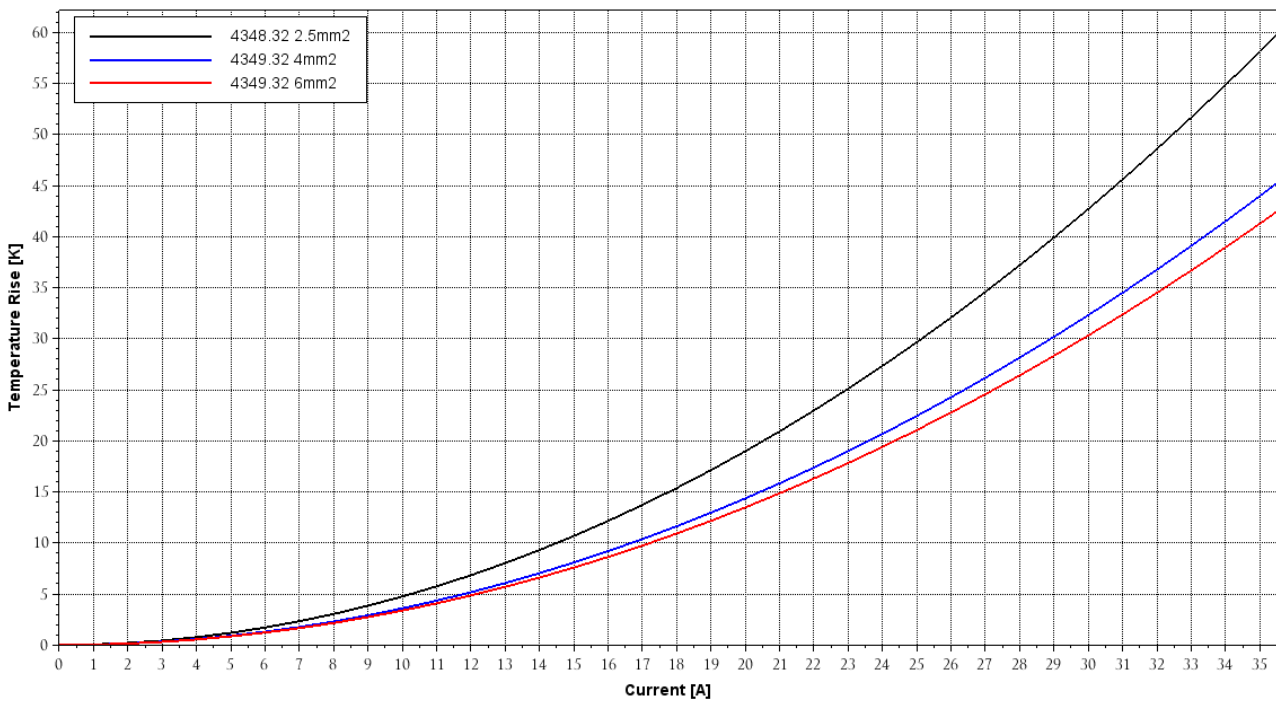

Curves show terminal behavior in a first connection, working in open air (without connector). Security margin has been applied.

Disclaimer

Data obtained from Escubedo Laboratory essays, using own methodology, cabling, equipment and original crimping tools, done in laboratory conditions and following the indicated standards, errors and omissions excepted. This document has no contractual meaning and it is published only for informative purposes. It can be changed without prior notice. The end customer has the sole responsibility to check these characteristics in its environment and with its own components, manufacturing methods and equipment. See also the full range product overview if available. For further information please visit our web site or contact us.

Rev. Nr.	Concept	Date	Created/Revised	Approved
4	Update curves	09/11/2015	D.Martinez / E.Roura	JC Sanchez
3	Update	01/07/2015	D.Martinez / E.Roura	JC Sanchez
2	Update	23/03/2011	D.Martinez	JC Sanchez