



5336.**

6.3 (.250) TYPE SERIES · FLAGS FOR CONNECTOR



Specification	Low insertion
Typology	Without Upper Dimple
For male (mm)	6,3x0,8
Wire size mm² (AWG)	1-2,5 (18-14)
Ø Insulation (mm)	2,7-3,8

Materials, temperature and contact resistance

Part nr.	Material	Finishing	Max. Temp. (°C)	Contact Resist (mΩ)
5336.24	Steel	Nickel-plated	300	1.00

Material thickness (mm) 0,45

Max. rated current

Wire section	5336.24
1.00 mm ²	12A
1.50 mm ²	16A
2.50 mm ²	20A

Insertion / Withdrawal forces



	5336.24
1st Insertion (max)	50N ¹
1st Withdrawal (max)	50N ¹
1st Withdrawal (min)	22N ¹
6th Withdrawal (min)	22N ¹

¹ Valid for Natural Brass Tab

Application tool MN5336

Wire strip length 4.5 (±0.5) mm

Crimping parameters & pull out force

Wire section (±10%)	Conductor 		Insulator 	Pull-out force (N)
	Height (mm)	Width (mm)	Width (mm)	
1.00 mm ²	1.80 (±0.05)	3.06 (±0.05)	4.10 (±0.10)	108N @ 60s
1.50 mm ²	1.90 (±0.05)	3.09 (±0.05)	4.11 (±0.10)	150N @ 60s
2.50 mm ²	2.15 (±0.05)	3.16 (±0.05)	4.19 (±0.10)	230N @ 60s

Values only valid for the application tool specified upwards. The insulator widths are only indicative as they are dependent on the sheath thickness of the wire used.

Winding number 3000

Compatible connectors

26337**, P8533**, P8534**, P8535**, R55310**-K, R55312**-K, R5532**-K, R5533**-K, R5534**-K, R5535**-K, R5536**-K, R5537**-K, R5538**-K, R5539**-K

Approvals





5336.**

6.3 (.250) TYPE SERIES · FLAGS FOR CONNECTOR



Drawing

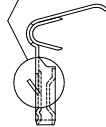
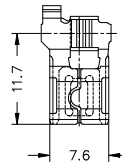
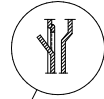
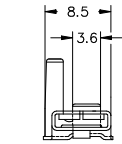



5336.24 NICKEL-PLATED STEEL
6.3 (.250) TYPE SERIES · FLAGS FOR CONNECTOR



Derating curve Current carrying capacity vs. Ambient temperature

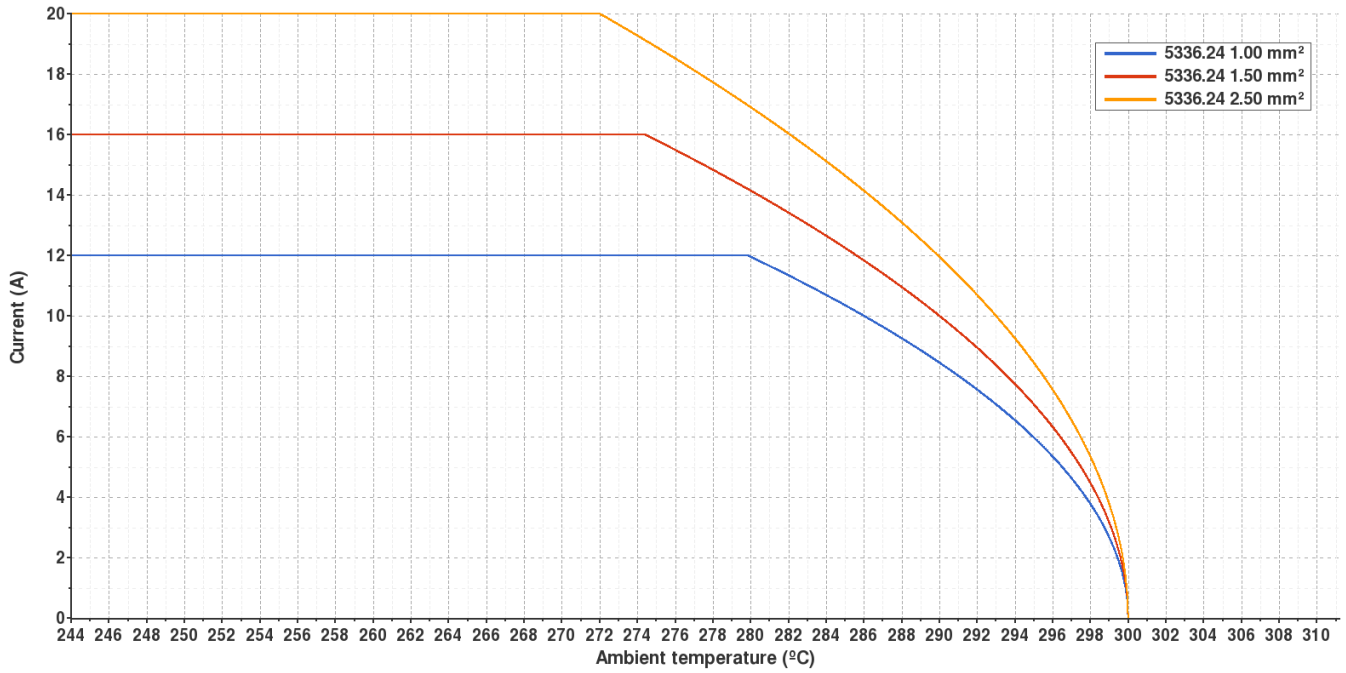

Temperature rise curve Terminal temperature rise due to the current carried

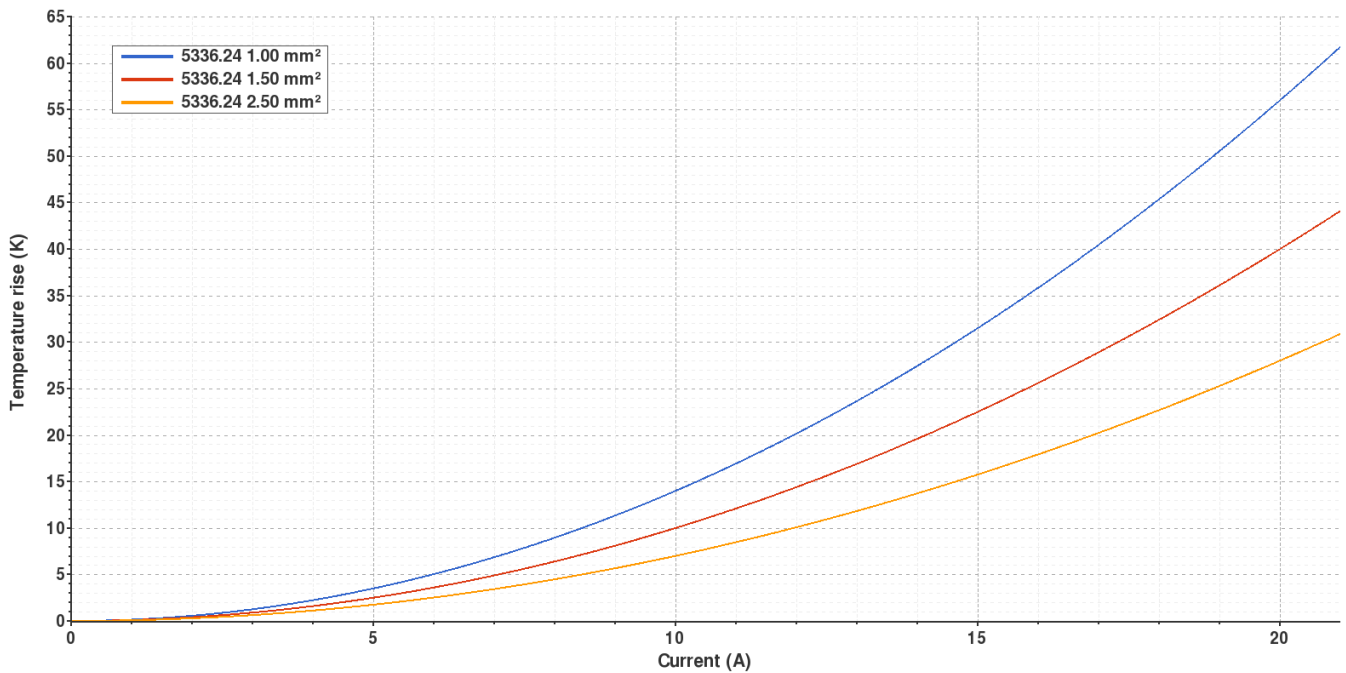

Valid for Natural Brass Tab



5336.**

6.3 (.250) TYPE SERIES · FLAGS FOR CONNECTOR



Disclaimer

Data obtained from Escubedo Laboratory essays, using own methodology, cablings, equipment and original crimping tools, done in laboratory conditions and following the indicated standards, errors and omissions excepted. This document has no contractual meaning and it is publicised only for informative purposes. It can be changed without prior notice. The end customer has the sole responsibility to check these characteristics in its environment and with its own components, manufacturing methods and equipment. See also the full range product overview if available. For further information please visit our web site or contact us

Rev. Nr.	Concept	Date	Created/Revised	Approved
A1	Datasheet generated automatically [A1]	2019-01-18	Laboratory Dept.	E. Roura

Especialitats Elèctriques Escubedo S.A.U. · Ctra. de Girona-Olot Km. 35,5 · 17843 Riudellots de la Creu · Girona · Spain
Tel.: 34 972 171 706 · Fax: +34 972 171 714 · info@escubedo.com · www.escubedo.com