

Product Overview / Características Principales

3873.02

Description / Descripción :Terminal Horquilla UP-Mag UP-Mag Fork terminal 90° Up / 90° Down / Straight
Wire size range / Rango de sección de cable: 0.80 – 2.0 mm <sup>2</sup>
Maximal insulator diameter / Diámetro máximo aislante: 3.6 mm
Strip – length / Longitud de pelada: 3.8 ± 0.2mm
Application Tool / Util de engaste: <b>MN3883 UP / DOWN</b>
Material / Material: Tin plated Brass / Latón Estañado
More info check/ Más info consultar : PT3873
Espesor / Thickness : 0.50 mm
Female part number: <b>6900/6901/6902/6904/6906/6908</b> Tin plated Brass

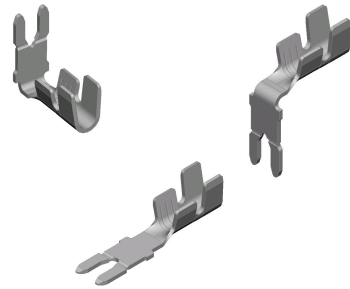

Test values / Resultados de ensayos

Insertion and withdrawal force (Efforts orientation according Connection)

	1° insertion thickness female 0.32mm	1° withdrawal thickness female 0.32mm	1° insertion thickness female 0.4mm	1° withdrawal thickness female 0.4mm
values	≤ 12 N	≥ 25 N	≤ 18 N	≥ 35 N

Current carrying capacity with maximal suitable wire size ( IEC 760 ) Capacidad de paso de corriente con la sección de cable mayor ( CEI 760 )	16A	
Maximal temperature ( DIN 46249 ) Temperatura máxima ( DIN 46249 )	110°C	Typical value Valor típico
Maximal contact resistance with minimal suitable wire size ( IEC 760 ) Máxima resistencia de contacto con la sección de cable menor ( CEI 760 )	-	0.39mΩ

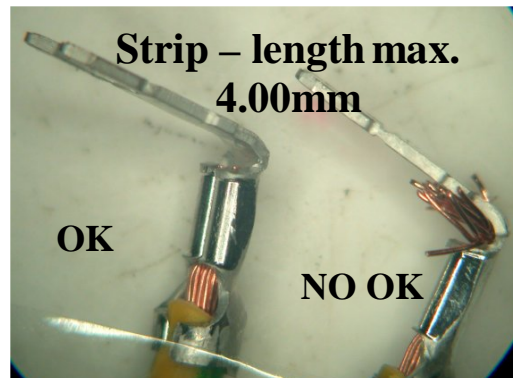

Wire size / Sección	Crimp data / Datos de engastadura			Pull-out-force	
	Inductor (±0.05)	Insulator (±0.1)		DIN 46249	typical
0.80 mm <sup>2</sup>	Altura 1.75	Anchura 2.69	Anchura 3.66	≥ 120 N	140 N
1.00 mm <sup>2</sup>	1.80	2.70	3.70	≥ 160 N	180 N
1.50 mm <sup>2</sup>	1.95	2.72	3.70	≥ 200 N	250 N
2.00 mm <sup>2</sup>	2.10	2.74	3.70	≥ 200 N	300 N

Values only valid for the application tool specified upwards / Valores válidos únicamente para el útil de engaste especificado arriba

Further information on request / Para más información consultar [info@escubedo.com](mailto:info@escubedo.com)

Nr/Nº	Modification/Modificación	Date/Fecha	Name/ Nombre	Approved / Aprobado
3	Crimp data and Pull-out-force modification	14/07/2010	David Martinez	Joan Carles Sanchez
2	Insertion and withdrawal force Modification	02/07/2009	David Martinez	Joan Carles Sanchez
1	Creation	10/06/2009	David Martinez	Joan Carles Sanchez

Disclaimer:

Data obtained from Escubedo Laboratory essays, using own methodology, cablings and equipment, done in laboratory conditions and following the indicated standards, errors and omissions excepted. This document has no contractual meaning and it is published only for informative purposes. It can be changed without prior notice. The end customer has the sole responsibility to check these characteristics in its environment and with its own components, manufacturing methods and equipment. See also the full range product overview if available. For further information please visit our web site or contact us.